

# the refreshing way to clean air

Philips have the answer to steam and stale air in these two reversible flow electric window fans.

They are quiet, lightweight, compact, easy to install, clean, good-looking and inexpensive! All this and years of reliability too.

For the kitchen, a two-speed model which will either suck steam and fumes out or draw clean, fresh air in. On switching off, a cover seals off rain and draughts automatically. BEAB Approved. Type HR3407.

Fitting couldn't be simpler for the home handyman. After the appropriate size hole has been cut in the selected pane there are three simple steps.

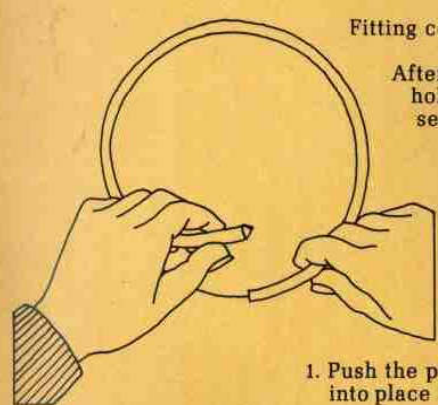

1. Push the plastic sealing ring into place round the hole.

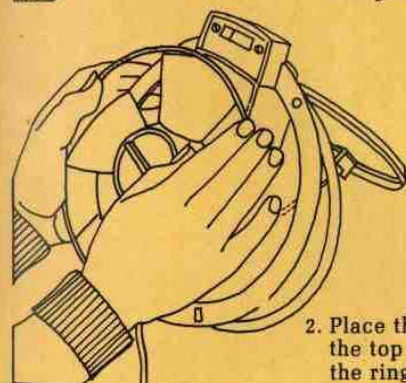

2. Place the fan in the hole, with the top plastic ribs fitting over the ring.

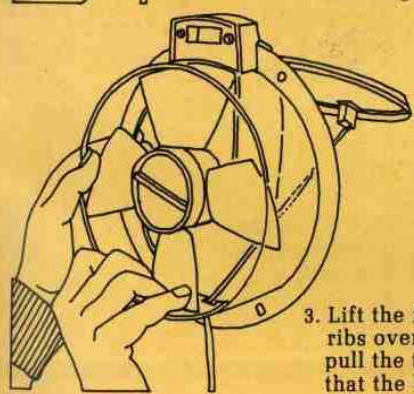

3. Lift the fan up — fit the bottom ribs over the edge of the ring — pull the fan down again so that the base touches the ring.

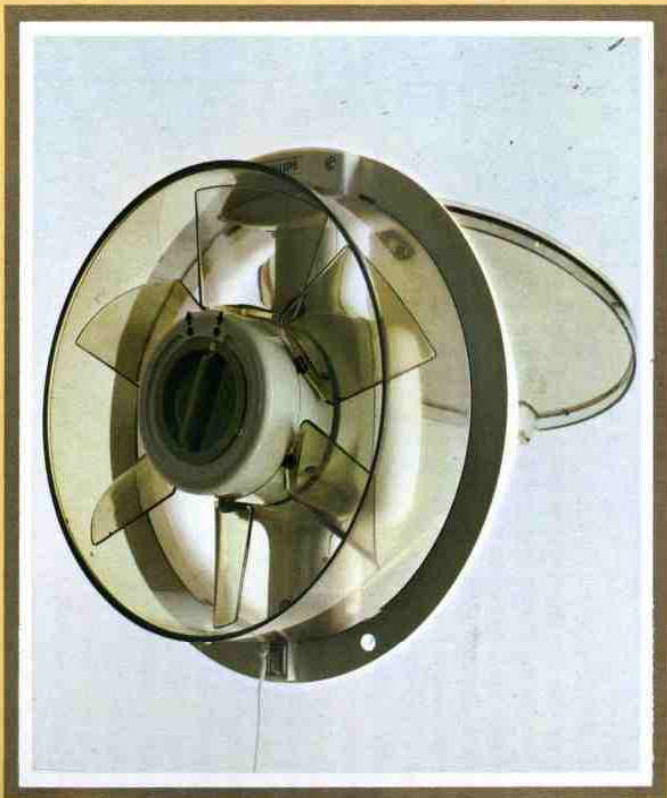

For smaller kitchens, bathrooms or WCs there's a single-speed variation. All the features of the other model. BEAB Approved. Type HR3404.

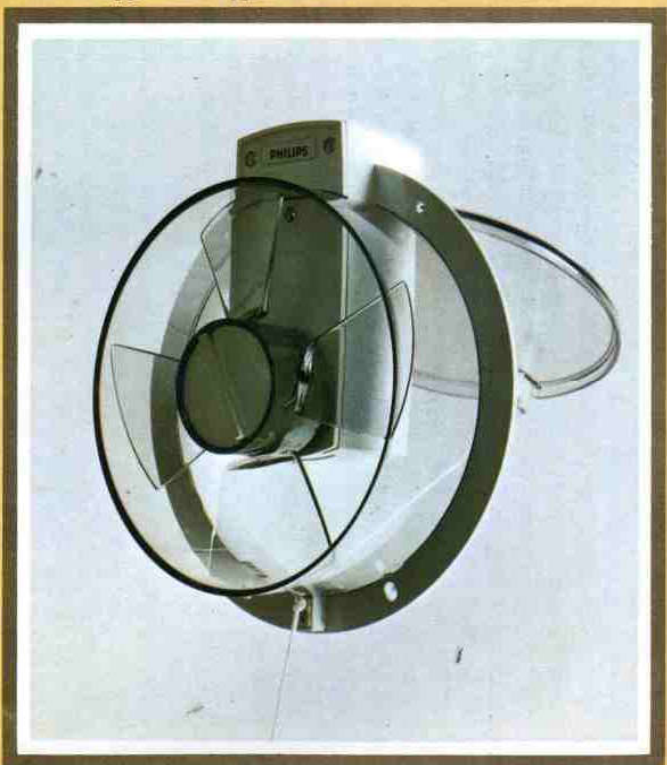

### WINDOW FANS

#### General

Voltage: 240 volts AC only.  
Safety: Class II double insulated. BEAB approved.  
Ease of use: Single cord operates on/off switch and weatherproof shutter. Pull off fan assembly for easy cleaning. Simple lever switch to change from extract to intake.  
Installation: See above.  
Connection: To be connected:  
i) to fixed wiring via double pole isolating switch OR  
ii) to any socket outlet via flexible cord.  
NB. Isolating switch and flexible cord not supplied.

#### HR3407

Loading—High speed: 42 W  
Low speed: 23 W  
Air displacement—High speed: 375 m<sup>3</sup>/hr (13,800 ft<sup>3</sup>/hr)  
Low speed: 275 m<sup>3</sup>/hr (10,000 ft<sup>3</sup>/hr)  
Overall diameter: 255 mm (10 in.)  
Fixing hole diameter: 238 mm (9 3/8 in.)

#### HR3404

Loading: 15 W.  
Air displacement: 200 m<sup>3</sup>/hr (7400 ft<sup>3</sup>/hr).  
Overall diameter: 200 mm (7 7/8 in.)  
Fixing hole diameter: 186 mm (7 3/8 in.)